

EP Distribution 2 Pole

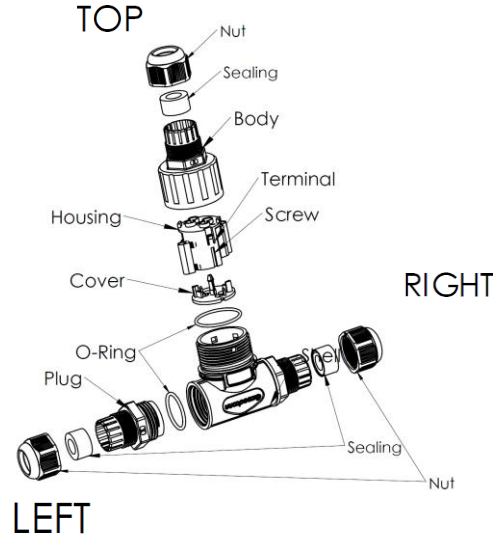
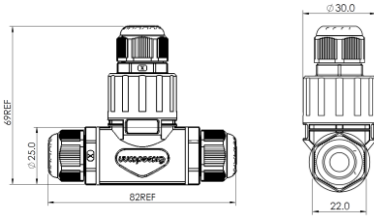

Technical parameter	
Rated Voltage	450V AC
Rated Current	24A
Rated Impulse Voltage	2500V
Contact Resistance	≤ 10mΩ
Insulation Resistance	≥ 500MΩ
Cable Retention Force	120N
Termination	Screw Clamp
Wire Gauge(mm ²)	0.5-2.5
Protection Degree	IP68 1M-24H
Working Temperature	-40°C ~+85°C
Material Of Housing	PA66 and PA66 30%GF
Material Of Contacts	Copper Alloy with Ni Plating
Standard According to	EN61984/EN60998-1 2004/EN60998-2-1 2004/EN62444 2013/CQC1101-2011/UL2238/UL1977

NO.	P/N	Sealing spec (TOP+LEFT+RIGHT)	Notes
1	910004101	φ8+φ8+φ8	Black
2	910004102	φ9.5+φ8+φ8	Black
3	910004103	φ11.5+φ8+φ8	Black
4	910004104	φ12.5+φ8+φ8	Black
5	910004105	φ8+φ9.5+φ8	Black
6	910004106	φ9.5+φ9.5+φ8	Black
7	910004107	φ11.5+φ9.5+φ8	Black
8	910004108	φ12.5+φ9.5+φ8	Black
9	910004109	φ8+φ11.5+φ8	Black
10	910004110	φ9.5+φ11.5+φ8	Black
11	910004111	φ11.5+φ11.5+φ8	Black
12	910004112	φ12.5+φ11.5+φ8	Black
13	910004113	φ8+φ12.5+φ8	Black
14	910004114	φ9.5+φ12.5+φ8	Black
15	910004115	φ11.5+φ12.5+φ8	Black
16	910004116	φ12.5+φ12.5+φ8	Black
17	910004117	φ8+φ12.5+φ9.5	Black
18	910004118	φ9.5+φ12.5+φ9.5	Black
19	910004119	φ11.5+φ12.5+φ9.5	Black
20	910004120	φ12.5+φ12.5+φ9.5	Black
21	910004121	φ8+φ12.5+φ11.5	Black
22	910004122	φ9.5+φ12.5+φ11.5	Black
23	910004123	φ11.5+φ12.5+φ11.5	Black
24	910004124	φ12.5+φ12.5+φ11.5	Black
25	910004125	φ8+φ12.5+φ12.5	Black
26	910004126	φ9.5+φ12.5+φ12.5	Black
27	910004127	φ11.5+φ12.5+φ12.5	Black
28	910004128	φ12.5+φ12.5+φ12.5	Black
29	910004129	φ8+φ8+φ0	Black
30	910004130	φ9.5+φ8+φ0	Black
31	910004131	φ11.5+φ8+φ0	Black
32	910004132	φ12.5+φ8+φ0	Black
33	910004133	φ8+φ9.5+φ0	Black
34	910004134	φ9.5+φ9.5+φ0	Black
35	910004135	φ11.5+φ9.5+φ0	Black
36	910004136	φ12.5+φ9.5+φ0	Black
37	910004137	φ8+φ11.5+φ0	Black
38	910004138	φ9.5+φ11.5+φ0	Black
39	910004139	φ11.5+φ11.5+φ0	Black
40	910004140	φ12.5+φ11.5+φ0	Black
41	910004141	φ8+φ12.5+φ0	Black
42	910004142	φ9.5+φ12.5+φ0	Black
43	910004143	φ11.5+φ12.5+φ0	Black
44	910004144	φ12.5+φ12.5+φ0	Black

EP Distribution 3 Pole

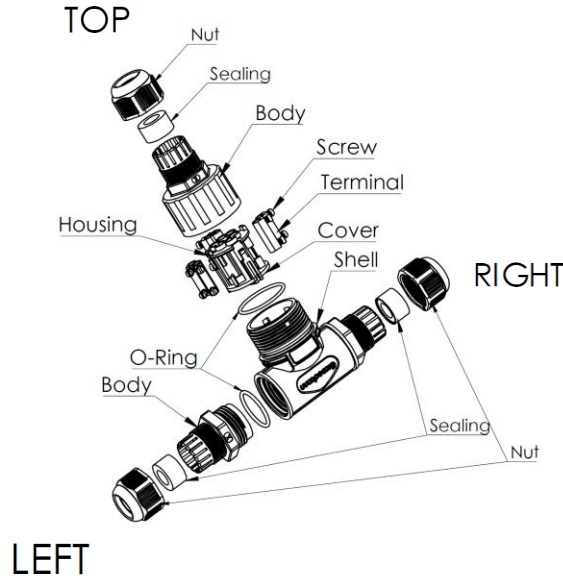
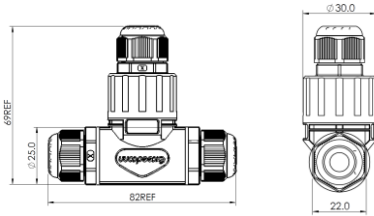

Technical parameter	
Rated Voltage	450V AC
Rated Current	24A
Rated Impulse Voltage	2500V
Contact Resistance	≤ 10mΩ
Insulation Resistance	≥ 500MΩ
Cable Retention Force	120N
Termination	Screw Clamp
Wire Gauge(mm ²)	0.5~2.5
Protection Degree	IP68 1M-24H
Working Temperature	-40°C ~+85°C
Material Of Housing	PA66 and PA66 30%GF
Material Of Contacts	Copper Alloy with Ni Plating
Standard According to	EN61984/EN60998-1 2004/EN60998-2-1 2004/EN62444 2013/CQC1101-2011/UL2238/UL1977

NO.	P/N	Sealing spec (TOP+LEFT+RIGHT)	Notes
1	910004201	φ8+φ8+φ8	Black
2	910004202	φ9.5+φ8+φ8	Black
3	910004203	φ11.5+φ8+φ8	Black
4	910004204	φ12.5+φ8+φ8	Black
5	910004205	φ8+φ9.5+φ8	Black
6	910004206	φ9.5+φ9.5+φ8	Black
7	910004207	φ11.5+φ9.5+φ8	Black
8	910004208	φ12.5+φ9.5+φ8	Black
9	910004209	φ8+φ11.5+φ8	Black
10	910004210	φ9.5+φ11.5+φ8	Black
11	910004211	φ11.5+φ11.5+φ8	Black
12	910004212	φ12.5+φ11.5+φ8	Black
13	910004213	φ8+φ12.5+φ8	Black
14	910004214	φ9.5+φ12.5+φ8	Black
15	910004215	φ11.5+φ12.5+φ8	Black
16	910004216	φ12.5+φ12.5+φ8	Black
17	910004217	φ8+φ12.5+φ9.5	Black
18	910004218	φ9.5+φ12.5+φ9.5	Black
19	910004219	φ11.5+φ12.5+φ9.5	Black
20	910004220	φ12.5+φ12.5+φ9.5	Black
21	910004221	φ8+φ12.5+φ11.5	Black
22	910004222	φ9.5+φ12.5+φ11.5	Black
23	910004223	φ11.5+φ12.5+φ11.5	Black
24	910004224	φ12.5+φ12.5+φ11.5	Black
25	910004225	φ8+φ12.5+φ12.5	Black
26	910004226	φ9.5+φ12.5+φ12.5	Black
27	910004227	φ11.5+φ12.5+φ12.5	Black
28	910004228	φ12.5+φ12.5+φ12.5	Black
29	910004229	φ8+φ8+φ0	Black
30	910004230	φ9.5+φ8+φ0	Black
31	910004231	φ11.5+φ8+φ0	Black
32	910004232	φ12.5+φ8+φ0	Black
33	910004233	φ8+φ9.5+φ0	Black
34	910004234	φ9.5+φ9.5+φ0	Black
35	910004235	φ11.5+φ9.5+φ0	Black
36	910004236	φ12.5+φ9.5+φ0	Black
37	910004237	φ8+φ11.5+φ0	Black
38	910004238	φ9.5+φ11.5+φ0	Black
39	910004239	φ11.5+φ11.5+φ0	Black
40	910004240	φ12.5+φ11.5+φ0	Black
41	910004241	φ8+φ12.5+φ0	Black
42	910004242	φ9.5+φ12.5+φ0	Black
43	910004243	φ11.5+φ12.5+φ0	Black
44	910004244	φ12.5+φ12.5+φ0	Black

Официальный дистрибутор Exceedconn в России – компания «Альтаир»

Комплексные поставки электронных компонентов точно под проект

Тел.: 7 (812) 333-03-67

Email: info@altaircom.ru

<http://www.altaircom.ru/>

Адрес: 197375, г. Санкт-Петербург, ул.Репищева, д.20, офис 413 БЦ "Sky Trade"

ИНН 7814618624 **КПП** 781401001

