

# HF9316

## HALF-SIZE CRYSTAL CAN SENSITIVE HERMETICALLY SEALED ELECTROMAGNETIC RELAY



### Features

- Sensitive type
- Coil power can be 0.5W
- Failure rate level can be level M
- All metal welded construction
- Hermetically welded and marked by laser

Conform to GJB65B-99 ( Equivalent to MIL-PRF-39016)

### AMBIENT ADAPTABILITY

Ambient grade	I	II	III
Ambient temperature	-55 °C to 85 °C	-55 °C to 85 °C	-65 °C to 125 °C
Humidity			98 %, 40 °C
Low air pressure	58.53 kPa	4.39 kPa	4.39 kPa
Sine vibration	Frequency	10 Hz to 1000 Hz	10 Hz to 2500 Hz
	Acceleration	147 m/s <sup>2</sup>	196 m/s <sup>2</sup>
Shock resistance	490 m/s <sup>2</sup>	490 m/s <sup>2</sup>	490 m/s <sup>2</sup>
Random vibration	—	20 (m/s <sup>2</sup> ) <sup>2</sup> /Hz	40 (m/s <sup>2</sup> ) <sup>2</sup> /Hz
Steady-state acceleration			490 m/s <sup>2</sup>

### CONTACT DATA

Ambient grade	I	II	III
Arrangement			2 C
Contact resistance	Initial max.		50 mΩ
	After life max.		100 mΩ

### Contact ratings

Ambient grade	Contact load	Type	Electrical life min.
I	2 A 28 Vd.c.	Resistive	5 x 10 <sup>4</sup> ops
	2 A 28 Vd.c.	Resistive	5 x 10 <sup>4</sup> ops
II	0.1 A 115 Va.c.	Resistive	1 x 10 <sup>5</sup> ops
	0.5 A 28 Vd.c. 200 mH	Inductive	1 x 10 <sup>5</sup> ops
III	2 A 28 Vd.c.	Resistive	1 x 10 <sup>5</sup> ops
	0.1 A 115 Va.c.	Resistive	1 x 10 <sup>5</sup> ops
	0.5 A 28 Vd.c. 200 mH	Inductive	1 x 10 <sup>5</sup> ops
	0.1 A 28 Vd.c.	Lamp load	1 x 10 <sup>5</sup> ops
	50 μA 50 mVd.c.	Low level	1 x 10 <sup>5</sup> ops



HONGFA HERMETICALLY SEALED RELAY

## SPECIFICATION

Ambient grade		I	II	III
Insulation resistance min.		1000 MΩ (@ 500 Vd.c.)	10000 MΩ (@ 500 Vd.c.)	10000 MΩ (@ 500 Vd.c.)
Dielectric strength min. (Normal condition)	Between open contacts	500 Vr.m.s.	500 Vr.m.s.	500 Vr.m.s.
	Between contact & coil	750 Vr.m.s.	1000 Vr.m.s.	1000 Vr.m.s.
	Between contact & cover	750 Vr.m.s.	1000 Vr.m.s.	1000 Vr.m.s.
	Between contact group	750 Vr.m.s.	1000 Vr.m.s.	1000 Vr.m.s.
	Between coil & cover	500 Vr.m.s.	500 Vr.m.s.	500 Vr.m.s.
Dielectric strength min. (Low air pressure condition)		350 Vr.m.s.	350 Vr.m.s.	350 Vr.m.s.
Leakage rate max.		1 Pa·cm <sup>3</sup> /s	1 x 10 <sup>-1</sup> Pa·cm <sup>3</sup> /s	1 x 10 <sup>-3</sup> Pa·cm <sup>3</sup> /s
Operate time max.		6 ms		
Release time max.		5 ms		
Mounting style		See the mounting dimension		
Terminals		See the terminal styles		
Work position		Random		
Weight max.		13 g		

## COIL DATA

Norminal coil power	Approx.0.5W
---------------------	-------------

### Coil Version

Order Number	Coil voltage		at 25 °C					-65°C to 125°C			
	Nominal voltage	Value max.	Coil resistance (1±10%) Ω	Pick-up voltage max.		Hold voltage max.	Drop-out voltage min.	Pick-up voltage max.		Hold voltage max.	Drop-out voltage min.
				I	II, III			I	II, III		
005	5	7	47	3.0	2.7	1.32	0.18	4.0	3.8	1.9	0.10
006	6	9	75	3.6	3.2	1.65	0.21	4.8	4.5	2.4	0.12
012	12	20	310	7.2	6.4	3.35	0.42	9.6	9.0	4.8	0.24
027	27	35	1030	16.2	13.5	6.90	0.95	21.6	18.0	10.0	0.54

Notes: We can offer many kinds of coil voltage under the requirement of users.

## ORDERING INFORMATION

Type	HF9316	-012	M	-0	1	- I
Order Number	005、006、012、027、036					
Failure Rate	L: Failure rate level L (level III products available) <sup>1)</sup> M: Failure rate level M (level III products available) <sup>1)</sup> Nil: Without failure rate requirement(level I ,II ,IIIproducts available)					
Mounting Style	0、1、2、3 (See the mounting dimension)					
Terminals Style	1、4 (See " Terminal styles " below)					
Ambient Grade	I : level I    II : level II    III: level III					

Notes: 1)For the failure rate of L or M ,the letter "III" of ambient grade level will not appear on relay cover.

**Outline Dimension**

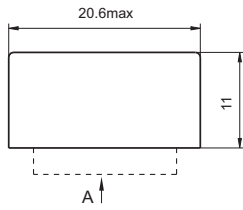

A direction

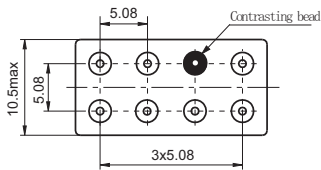

**Mouting style 0**

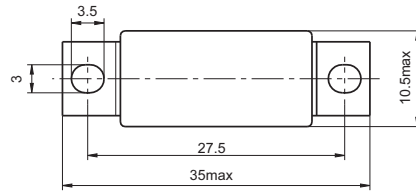
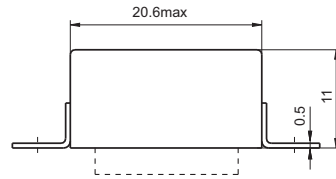

**Mouting style 1**

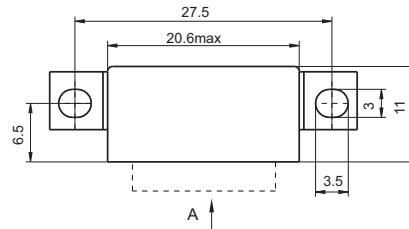
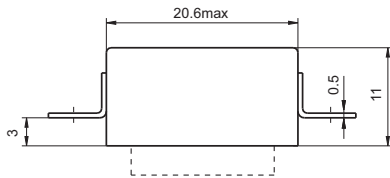

A ↑

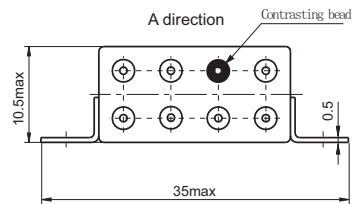
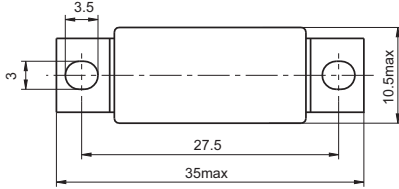

**Mouting style 3**

**Mouting style 2**

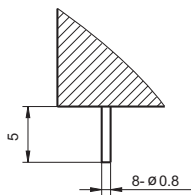

**Terminal style 1  
(Solder pin)**

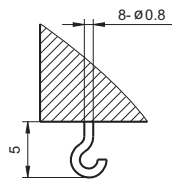

**Terminal style 4  
(Solder hook)**

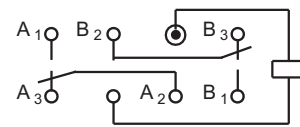

**Wiring Diagram  
(Bottom View)**

**Disclaimer**

This datasheet is for the customers' reference. All the specifications are subject to change without notice.

© Xiamen Hongfa Hermetically Sealed Relays Co., Ltd. All rights of Hongfa are reserved.