

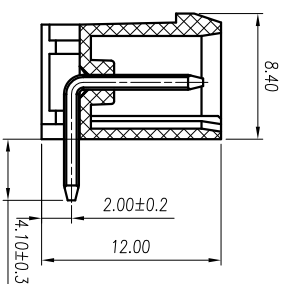

# 慈溪市万捷电子有限公司 CIXI WANJIE ELECTRONIC CO., LTD

产品规格书  
THE SPEC SHEET

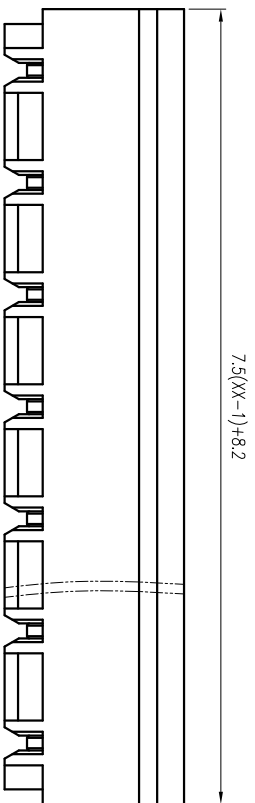
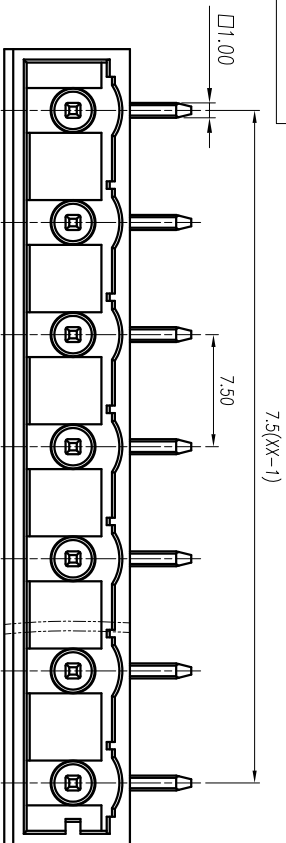
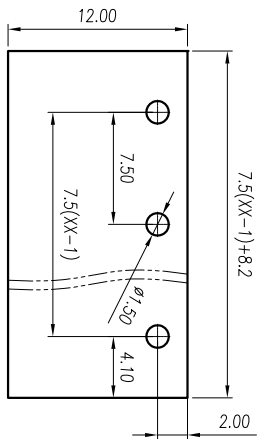

参考标准/Standard	UL	IEC
额定电压/Rated voltage	300V	450V
额定电流/Rated current	15A	20A
接触电阻/Contact resistance	20mΩ	
绝缘电阻/Insulation resistance	500MΩ/DC500V	
耐压/With standing voltage	AC 2000V/1 Min	
机械性能/Mechanical		
温度范围/Temp Range	-40°C~+105°C	
瞬时温度/MAX Soldering	+250°C for 5 Sec	
尺寸/Dimensions		
间距/Pitch	7.5mm	
极数/Poles	2-24p	
材质及电镀/Material	PA66, UL94V-0	
塑件/Housing	Brass, Tin plated	
焊脚/Pin header		

tolerance	linear dimension(Tolerances Standard GB/T 14486-2008)	≡	—	□	//	⊥										
	variable range	6 to 10	6 to 10	10 to 18	18 to 30	30 to 50	50 to 80	80 to 120	120 to 160	160 to 200	200 to 250	250 to 250	all to 5	5 to 30	30 to 120	120 to 120
tolerance	±0.1	±0.14	±0.19	±0.25	±0.32	±0.43	±0.57	±0.72	±0.88	±1.05	±1.25	0.5	0.025	0.06	0.12	0.4

单位/UNITS	mm	尺寸/SIZE	A4	比例/SCALE	2:1
第三视图/THIRD ANGLE PROJECTION					
名称/TITLE	WJ0602-02XX-1YY-00A				



慈溪市万捷电子有限公司  
CIXI WANJIE ELECTRONIC CO., LTD