

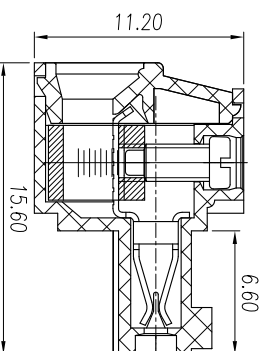

慈溪市万捷电子有限公司 CIXI WANJIE ELECTRONIC CO., LTD

产品规格书
THE SPEC SHEET

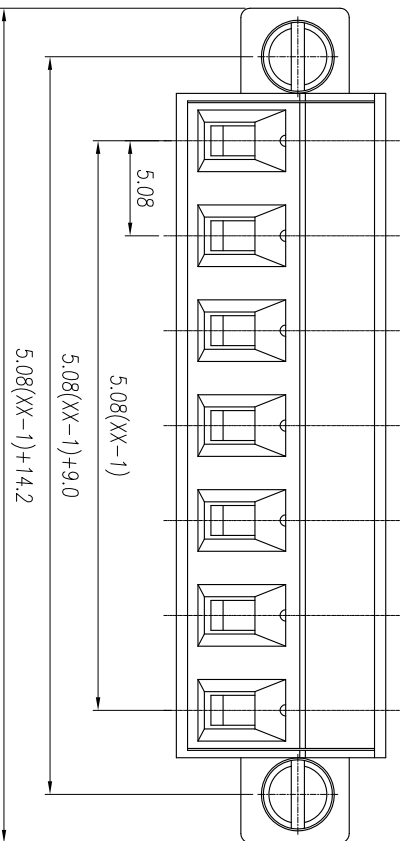
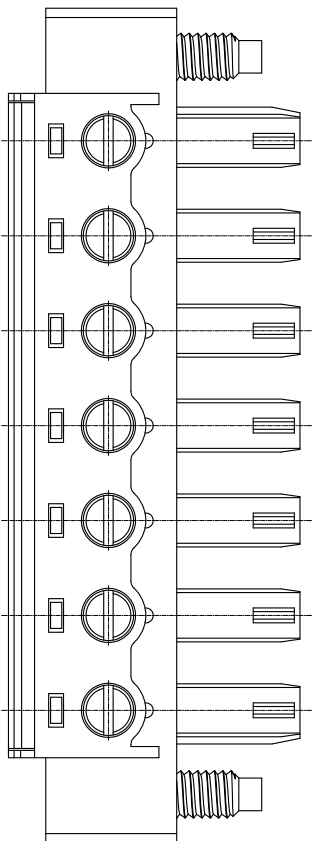

参考标准 / Standard	UL	IEC
额定电压 / Rated voltage	300V	250V
额定电流 / Rated current	8A	10A
接触电阻 / Contact resistance	20mΩ	
绝缘电阻 / Insulation resistance	500MΩ /DC500V	
使用线径 / Wire range	28~16AWG	1.0mm ²
耐电压 / With standing voltage	AC 2000V/1 Min	
机械性能 / Mechanical		
最大扭矩 / Torque(Max)	0.2Nm(1.7Lb.in)	
剥线长度 / Strip Length	6-7mm	
温度范围 / Temp. Range	-40°C~+105°C	
尺寸 / Dimensions		
间距 / Pitch	5.08mm	
极数 / Poles	2-24p	
材质及电镀 / Material	PA66, UL94V-0	
塑件 / Housing	M2.0 Steel, Zn plated	
螺丝 / Screws	Phosphor bronze, Ni plated	
夹子 / Clamp	Brass, Ni plated	
方块 / Cage		

linear dimension (Tolerances Standard GB/T 14486-2008)	≡	—	□	//	⊥											
tolerance	±0.1	±0.14	±0.19	±0.25	±0.32	±0.43	±0.57	±0.72	±0.88	±1.05	±1.25	0.5	0.025	0.06	0.12	0.4
variable range	6 to	6 to	10 to	18 to	30 to	50 to	80 to	120 to	160 to	200 to	250 to	all	5 to	5 to	30 to	120 to
tolerance	±0.1	±0.14	±0.19	±0.25	±0.32	±0.43	±0.57	±0.72	±0.88	±1.05	±1.25	0.5	0.025	0.06	0.12	0.4

单位 / UNITS	mm	尺寸 / SIZE	A4	比例 / SCALE	2:5:1
慈溪市万捷电子有限公司 CIXI WANJIE ELECTRONIC CO., LTD					
名称 / TITLE	第三视角 / THIRD ANGLE PROJECTION WJ15ED3MM-5.08-XXP-1YY-00A				