

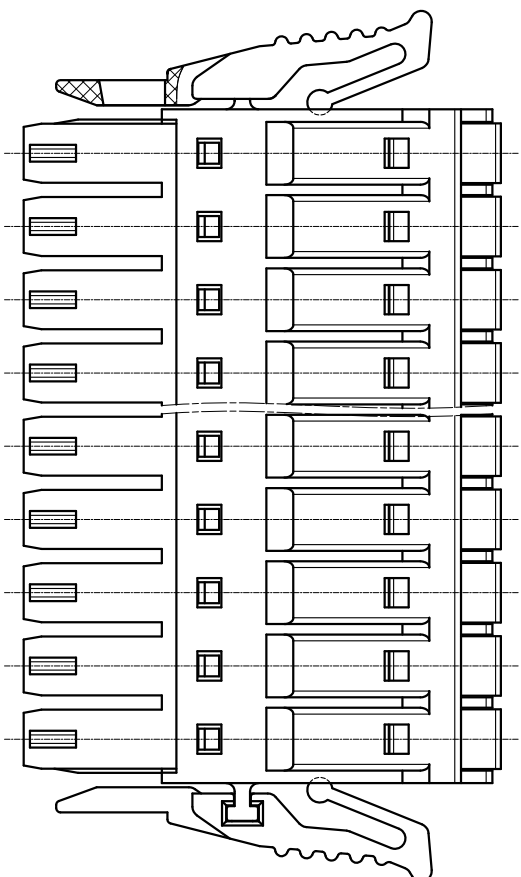

# 慈溪市万捷电子有限公司 CIXI WANJIE ELECTRONIC CO., LTD

产品规格书  
THE SPEC SHEET

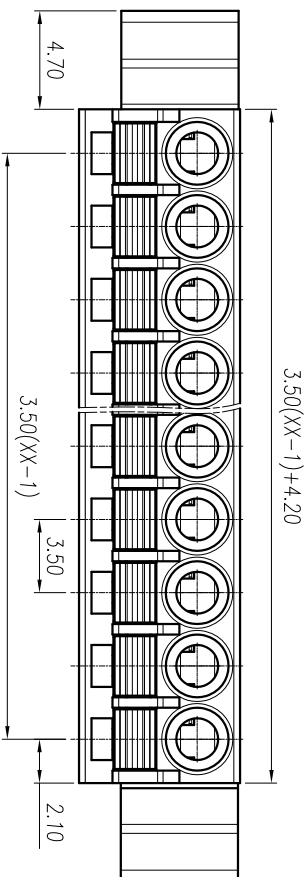
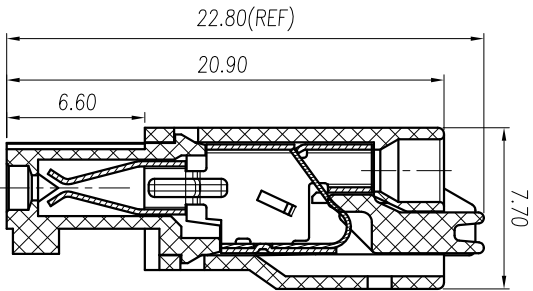
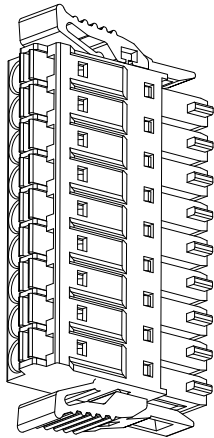

### 电气性能 / Electrical

参考标准 / Standard: UL IEC  
 额定电压 / Rated voltage: 300V 250V  
 额定电流 / Rated current: 8A 10A  
 接触电阻 / Contact resistance: 20mΩ

使用线径 / Wire range: 24-16AWG 1.0mm<sup>2</sup>

耐电压 / Withstanding voltage: AC2000V/1Min

绝缘电阻 / Insulation resistance: 500MΩ /DC300V

### 机械性能 / Mechanical

温度范围 / Temp Range: -40°C+105°C

剥线长度 / Strip length: 9-10mm

### 尺寸 / Dimensions

间距 / Pitch: 3.5mm,

极数 / Poles: 2P-24P

### 材料及电镀 / Material

塑件 / Housing: PA66, UL94V-0

夹片 / Clamp: Phosphor bronze / Tin plated

弹片 / Strapnel: stainless steel

linear dimension(Tolerances Standard GB/T 14486-2008)

|                |      |       |       |       |       |       |       |        |        |        |        |     |       |      |       |        |
|----------------|------|-------|-------|-------|-------|-------|-------|--------|--------|--------|--------|-----|-------|------|-------|--------|
| tolerance      | ±0.1 | ±0.14 | ±0.19 | ±0.25 | ±0.32 | ±0.43 | ±0.57 | ±0.72  | ±0.88  | ±1.05  | ±1.25  | 0.5 | 0.025 | 0.06 | 0.12  | 0.4    |
| variable range | 6 to | 6 to  | 10 to | 18 to | 30 to | 50 to | 80 to | 120 to | 160 to | 200 to | 250 to | all | 5 to  | 5 to | 30 to | 120 to |
|                | over | over  | over  | over  | over  | over  | over  | over   | over   | over   | over   |     | over  | over | over  | over   |

单位 / UNITS mm 尺寸 / SIZE A4 比例 / SCALE 3:1

第三视图 / THIRD ANGLE PROJECTION



慈溪市万捷电子有限公司  
CIXI WANJIE ELECTRONIC CO., LTD

名称 / TITLE WJ15EDGKNG-3.5-XXP-1YY-00A