

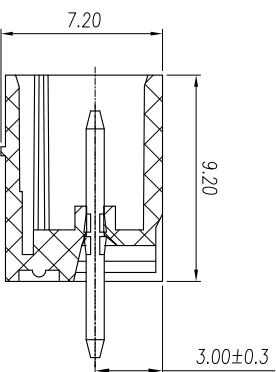

慈溪市万捷电子有限公司
CIXI WANJIE ELECTRONIC CO., LTD

产品规格书
THE SPEC SHEET

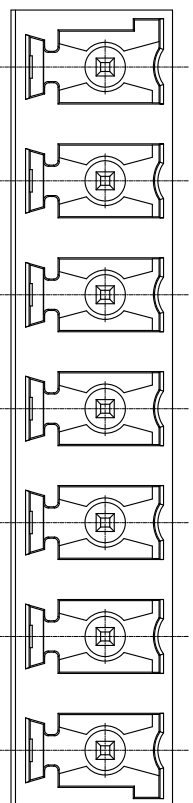
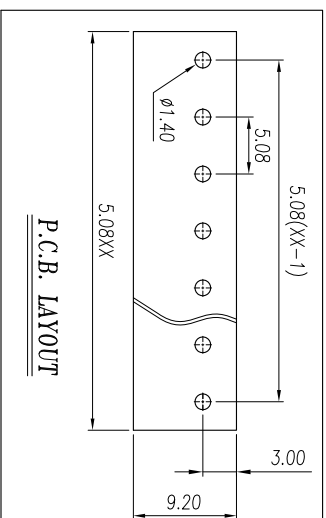
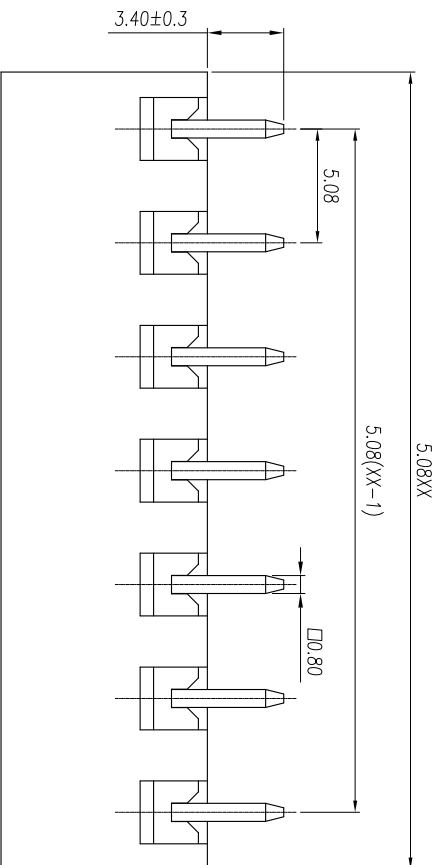

参考标准/Standard	UL	IEC
额定电压/Rated voltage	300V	250V
额定电流/Rated current	8A	10A
接触电阻/Contact resistance	20mΩ	
绝缘电阻/Insulation resistance	500MΩ/DC500V	
耐电压/With standing voltage	AC 2000V/1 Min	
机械性能/Mechanical		
温度范围/Temp.Range	-40°C~+105°C	
瞬间温度/Temp.Range	+250°C	5秒

尺寸/Dimensions	5.08mm
间距/Pitch	2-24p
极数/Poles	PA66, UL94V-0
材料及电镀/Material	Brass, Tin plated
塑件/Housing	
焊脚/Pin header	

Variable range	tolerance	±0.1	±0.14	±0.19	±0.25	±0.32	±0.43	±0.57	±0.72	±0.88	±1.05	±1.25	0.5	0.025	0.06	0.12	0.4
	tolerance	±0.1	±0.14	±0.19	±0.25	±0.32	±0.43	±0.57	±0.72	±0.88	±1.05	±1.25	0.5	0.025	0.06	0.12	0.4

linear dimension(Tolerances Standard GB/T 14486-2008)

≡ — □ // ⊥

单位/UNITS mm 尺寸/ SIZE A4 比例/ SCALE 3:1

第三视角/THIRD ANGLE PROJECTION



慈溪市万捷电子有限公司
CIXI WANJIE ELECTRONIC CO., LTD

名称/TITLE
WJ5ED9VC-5.08-XXP-1YY-00A

