



# 慈溪市万捷电子有限公司

## CIXI WANJIE ELECTRONIC CO., LTD

产品规格书  
product specification

### 电气性能/Electrical

参考标准/Standard: UL IEC  
 额定电压/Rated voltage: 300V 450V  
 额定电流/Rated current: 15A 24A  
 使用线径/Wire range: 22-14AWG 2.5mm<sup>2</sup>  
 耐压/Withstanding voltage: AC2000V/Min  
 绝缘电阻/Insulation resistance: 500M $\Omega$ /DC500V

### 机械性能/Mechanical

温度范围/Temp. Range: -40 $^{\circ}$ C~+105 $^{\circ}$ C  
 最大锁紧力矩/Max. Torque: 0.5Nm (4.5lb. in)

### 尺寸/Dimensions

间距/Pitch: 8.0mm  
 极数/Poles: 2P-XXP

### 材质及电镀/Material

塑件/Housing: PA66, UL94V-0  
 螺丝/Screws: M3, steel Nickel plated  
 焊脚/Pin header: Brass, 0.8, Tin plated

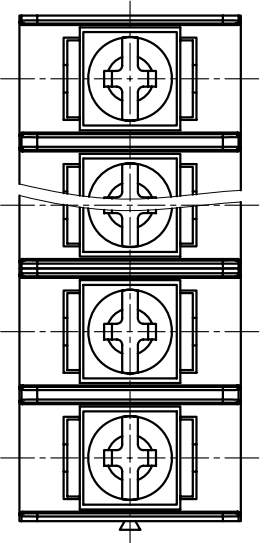
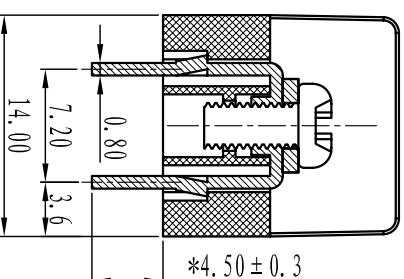
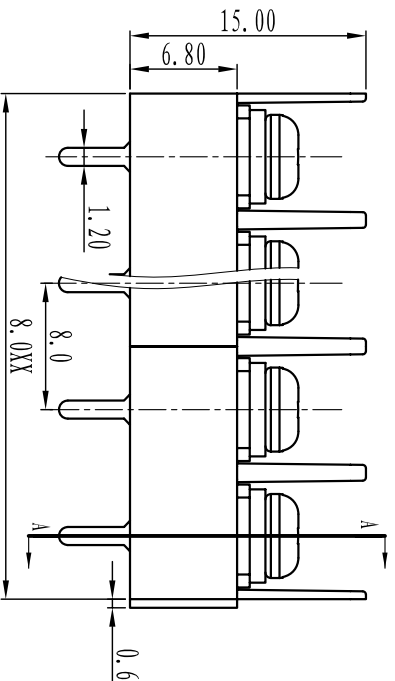

TOLERANCES EXCEPT AS NOTED

	linear dimension	fillet	chamfer	short angle sid	≡	—	□	//	⊥
variable range	over 6 to 30	over 30 to 120	over 480 to 480	all	to 6	over 6 to 10	over 10 to 50	over 50 to 120	all
tolerance	±0.1	±0.2	±0.3	±0.5	±0.9	±0.2	±0.5	±1	1 $^{\circ}$

### 订购方式 : HOW TO ORDER

型号/Model  
 极数/POLE  
 P  
 客户需求  
 客户需求

灰色/Grey	10	绿色/Green	40	透明/Transparent	70
蓝色/Blue	20	橙色/Orange	50	黄色/Yellow	80
黑色/Black	30	红色/Red	60	白色/White	90

单位/UNITS	mm	尺寸/SIZE	A4	比例/SCALE
----------	----	---------	----	----------

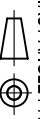

第一视角/FIRST ANGLE PROJECTION



慈溪市万捷电子有限公司  
CIXI WANJIE ELECTRONIC CO., LTD

名称/NAME

WJ32-XXP-1YY-00A