

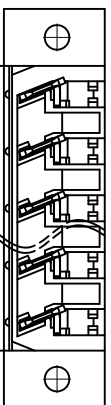

慈溪市万捷电子有限公司 CIXI WANJIE ELECTRONIC CO., LTD

产品规格书
THE SPEC SHEET

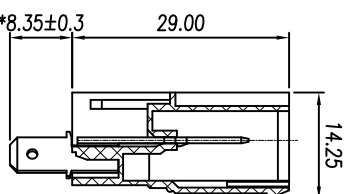
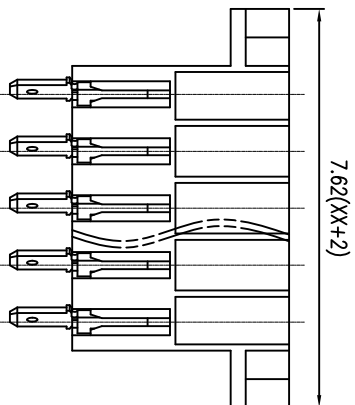
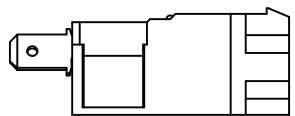
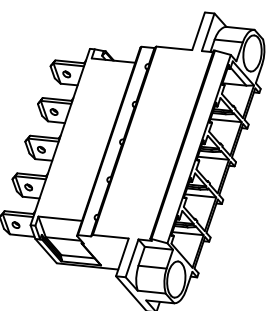
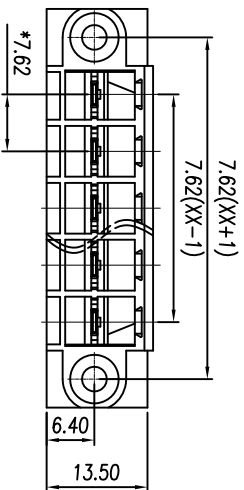

电气性能/Electrical	
参考标准/Standard	UL IEC
额定电压/Rated voltage	300V 600V
额定电流/Rated current	20A 32A
接触电阻/Contact resistance	20mΩ
绝缘电阻/Insulation resistance	500MΩ/DC500V
耐压/With standing voltage	AC 3000V/1 Min
机械性能/Mechanical	
温度范围/Temp. Range	-40°C~+105°C
瞬时温度/MAX Soldering	+250°C, for 5 Sec
尺寸/Dimensions	
间距/Pitch	7.62mm
极数/Poles	2-12P
材质及电镀/Material	PA66, UL94V-0
塑料/Housing	Red copper, Tin plated
导电针/Conductor	

linear dimension(Tolerances Standard GB/T 14486-2008)

tolerance	±0.1	±0.14	±0.19	±0.25	±0.32	±0.43	±0.57	±0.72	±0.88	±1.05	±1.25	0.5	0.025	0.06	0.12	0.4
variable range	6 to	6 to 10	10 to 18	18 to 30	30 to 50	50 to 80	80 to 120	120 to 160	160 to 200	200 to 250	250 to	all	5 to	5 to 30	30 to 120	120 to

单位/UNITS	mm	尺寸/SIZE	A4	比例/SCALE	1:1
----------	----	---------	----	----------	-----

名称/TITLE	第三视图/THIRD ANGLE PROJECTION
WJ3CDGM-7.62-XXP-1YY-00A	

慈溪市万捷电子有限公司
CIXI WANJIE ELECTRONIC CO., LTD